

# CONE CRUSHER CH SERIES CH430

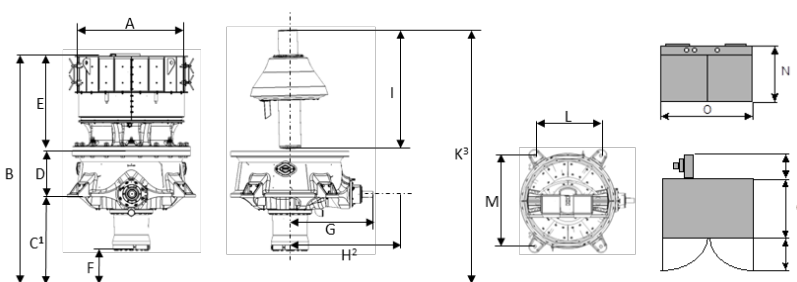

### DIMENSIONS (mm)

A	B	C <sup>1</sup>	D	E	F	G	H <sup>2</sup>	I	K <sup>3</sup>	L	M	N	O	P	Q	R
1360	2990	1130	660	1210	420	1060	1705	1690	3570	1676	1270	850	1156	861	770	650

### WEIGHTS (kg)

Feed hopper	Spider cap	Topshell, complete	Mainshaft assembly complete	Eccentric, complete	Bottomshell assembly complete	Pinionshaft housing complete	Hydroset cylinder complete	Total Weight (approx.)	Oil tank
230	130	2900	1840	410	3920	250	520	9200	270

### PERFORMANCE

Nominal capacities MTPH	Chamber	EC	C	MC	M	MF	F	EF
	CSS	95-110	75-90	-	-	-	-	-
	SH	160	130	105	80	70	45	34
	TS	185	145	115	90	75	50	38
Max motor power (kW)		132	132	132	132	132	132	132
Ecc. Throw (mm)		16-34	16-34	16-36	16-36	16-36	16-36	16-36
	4	-	-	-	-	-	32-47	-
	5	-	-	-	-	-	34-71	38-60
	6	-	-	-	-	42-49	35-78	40-89
	8	-	-	-	48-56	44-100	37-83	42-95
	10	-	60	57-79	50-113	47-106	39-88	45-101
	13	66-119	66-140	62-140	55-123	51-115	43-96	49-109
	16	71-151	71-151	67-151	59-133	55-124	46-92	52-105
	19	76-162	76-162	72-162	63-143	59-126	49-77	56-105
	22	81-173	81-173	77-173	68-152	63-114	53-63	60-71
	25	86-184	86-184	82-184	72-144	67-92	-	-
	29	93-198	93-198	88-160	78-122	-	-	-
	32	98-209	98-209	93-145	82-97	-	-	-
	35	104-220	104-207	98-116	-	-	-	-
	38	109-218	109-150	-	-	-	-	-
	41	114-157	114	-	-	-	-	-
Standard Mantles		A/B/FF	A/B/FF	A/B/HC/FF	A/B/HC	A/B/HC	A/B/HC	EF

